



**GUF** AUFASTER  
HARDWARE

Professional fastener & hardware  
components supplies

# ABOUT US

Aufast Co.,Ltd was established in 2004, with ISO9001 certificate, is a professional manufacturer and exporter specialized in various standard and nonstandard fasteners and hardware components.

We aim to supply the convenience of a package service from market research, through manufacturing and documentation, to shipment and delivery. With such a highly professional team we can provide high quality products and best service according to different customers' requirements.

Our dedication to customer service has helped us become one of the most respected fastener distributors in the Southeast and got good reputation in the world market.

The raw materials for the products are: carbon steel, alloy steel, stainless steel, brass. And the surface finishings like: zinc plated, black, zinc-plated, brass-plated, hot dip galvanized, mechanic zinc-plated, etc. The mechanical performance grade varies from 4.8-12.9 (ANSI GR2-GR5 B7), stainless steel 304-316. We also have different types of packages for customers' choice.

With our promise" Excellent quality, satisfactory service and everlasting business", we are serving global markets at very competitive price to achieve a win-win situation for our customers.



# CATALOG

Threaded Rods / Strut Channel .....	03-05
Bolt .....	06-09
Nut .....	10-14
Machine/ Wood / Tapping / Drilling Screw .....	15-22
Washer .....	23-23
Rivet Nut .....	24-25
Pin / Rivet / Anchor .....	26-27
Steel Link Chain .....	28-28
Wire Rope & Ringging .....	28-28





**AUFASER**  
HARDWARE

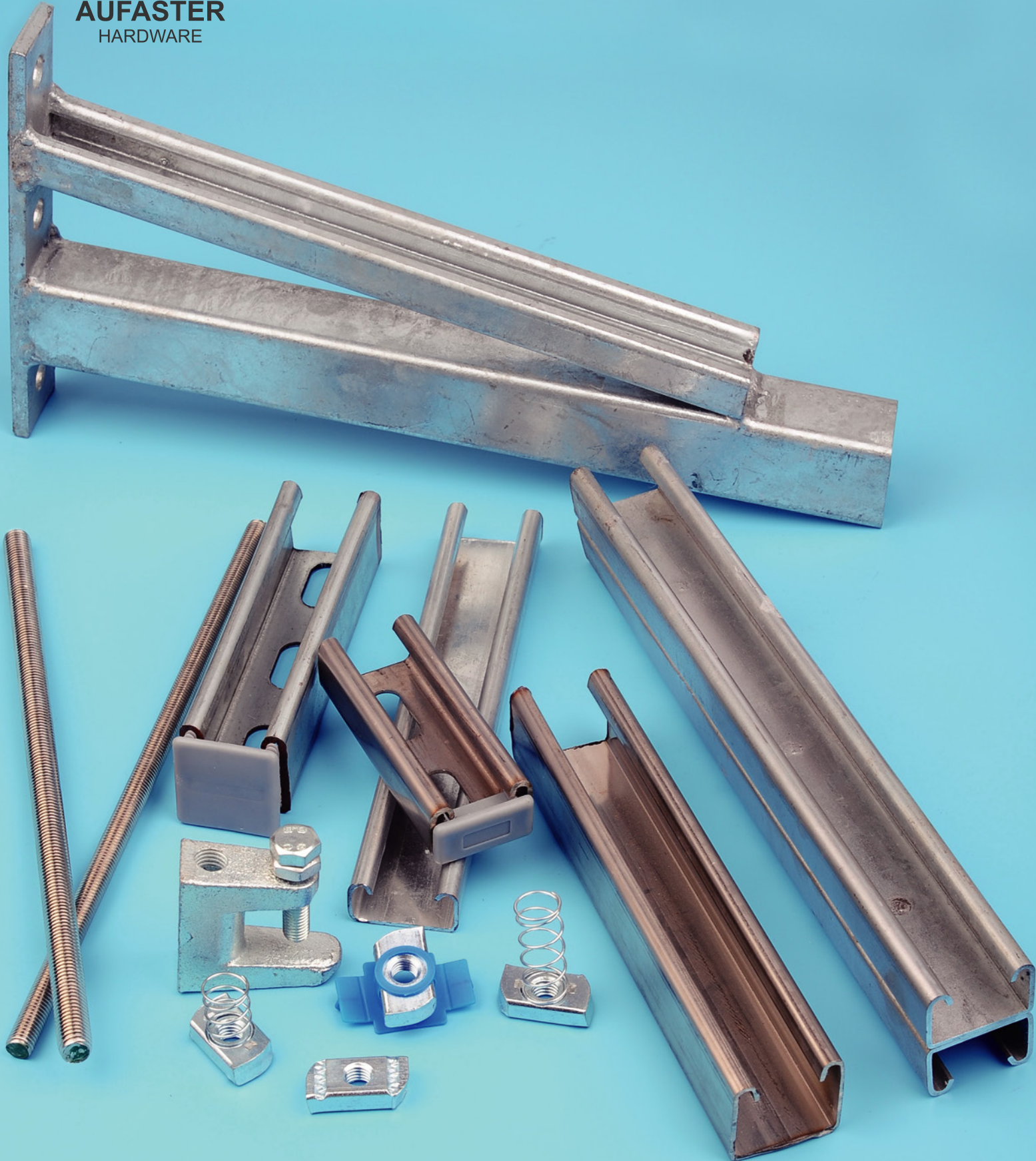

# Accessories of Construction

## Threaded Rods - Strut

### Threaded Rod

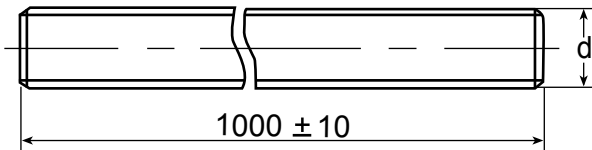

#### Standard: Din975

Dia.	Length M	Material /Class	Surface Treatment	Package Pcs/Bundle
M3-0.5	1,2,3			100
M4-0.7	1,2,3			100
M5-0.8	1,2,3			100
M6-1.0	1,2,3	4.8	PLAIN	100
M8-1.25	1,2,3	8.8	BLACK	100
M10-1.5	1,2,3	10.9	Z.P.L	50
M12-1.75	1,2,3	12.9	B.Z.P	25
M14-2.0	1,2,3	or	M.Z.P.	20
M16-2.0	1,2,3	SSA2/A4	H.D.G.	10
M18-2.5	1,2,3	Brass	Decromet	10
M20-2.5	1,2,3		Ruspert	10
M22-2.5	1,2,3			5
M22-2.5	1,2,3			5

#### Threaded Rod (ASTM)

Dia.	Length INCH	Material /Grade	Surface Treatment	Package Pcs/Bundle
12#-24	3',6',12'			100
1/4"-28	3',6',12'			100
5/16"-18	3',6',12'	2, 5, 8	PLAIN	100
3/8"-16	3',6',12'	or	BLACK	100
1/2"-13	3',6',12'	ASTM A193	Z.P.L	50
5/8"-11	3',6',12'	B7/B7M;	B.Z.P	25
3/4"-10	3',6',12'	B8/B8M	M.Z.P.	20
7/8"-9	3',6',12'	or	H.D.G.	10
1"-8	3',6',12'	SS A2/A4	Decromet	10
1-1/4"-7	3',6',12'	Brass	Ruspert	10
1-1/2"-6	3',6',12'			5
1-3/4"-5	3',6',12'			1

### Solid Strut Channel

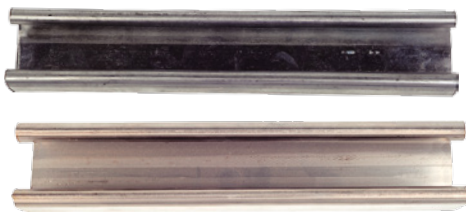

Dia.	Length M	Thickness MM	Surface Treatment	Package Pcs/Bundle
41*41				
41*21		1.6	PLAIN	
21*21	3, 6	2.0	GB	25
41*62		2.5	H.D.G.	50
41*82				

### Slotted Strut Channel



Dia.	Length M	Thickness MM	Surface Treatment	Package Pcs/Bundle
41*41				
41*21		1.6	PLAIN	
21*21	3, 6	2.0	GB	25
41*62		2.5	H.D.G.	50
41*82				

Hole size available:

11\*20, 13\*25, 14\*28, 25\*11, 28\*14, 35\*12

**Back-to-Back Strut Channel**



Dia.	Length M	Thickness MM	Surface Treatment	Package Pcs/Bundle
41*25		1.6		
41*42	3, 6	2.0	H.D.G.	25
41*82		2.5		50

**Braced Cantilever**



Dia.	Length M	Thickness MM	Surface Treatment	Package Pcs/Bundle
41*41		1.6		
41*21	DIY	2.0	H.D.G.	By Wooden Box
21*21		2.5		

**Unbraced Cantilever**



Dia.	Length M	Thickness MM	Surface Treatment	Package Pcs/Bundle
41*41		1.6		
41*21	DIY	2.0	H.D.G.	By Wooden Box
21*21		2.5		

**Beam Clamp**



Dia.	Length M	Thickness MM	Surface Treatment	Package Pcs/Bundle
M10	/	/	Z.P.	Bulk
M12			H.D.G.	

**Plastic End Closure Cap**

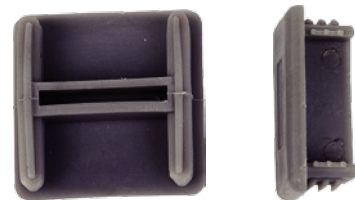

Dia.	Length M	Thickness MM	Surface Treatment	Package Pcs/Bundle
41*41	41*41mm			
41*21	41*21mm	/	/	/
21*21	3,6M			





**Hexagon Head Bolts, Half Thread**

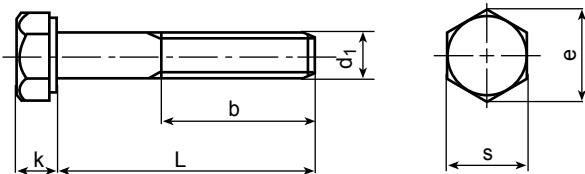

Standard: Din931

Dia.	Length MM	Material /Class	Surface Treatment	Package Pcs/Bundle
M4-0.7	8-40			/
M5-0.8	8-65			/
M6-1.0	10-120	4.8	PLAIN	/
M8-1.25	12-130	8.8	BLACK	/
M10-1.5	16-130	10.9	Z.P.L	/
M12-1.75	45-200	12.9	B.Z.P	/
M14-2.0	50-220		M.Z.P.	/
M16-2.0	60-280	or	H.D.G.	/
M18-2.5	60-300	SSA2/A4	Decromet	/
M20-2.5	60-380	Brass	Ruspert	/
M22-2.5	70-380			/

Fine thread bolt according to Din601, or Din960



Standard: Din6914-high strength hex bolt

Dia.	Length MM	Material /Class	Surface Treatment	Package Pcs/Bundle
M4-0.7	8-40			/
M5-0.8	8-65			/
M6-1.0	10-120		PLAIN	/
M8-1.25	12-130	8.8	BLACK	/
M10-1.5	16-130	10.9	Z.P.L	/
M12-1.75	45-200	12.9	B.Z.P	/
M14-2.0	50-220		M.Z.P.	/
M16-2.0	60-280		H.D.G.	/
M18-2.5	60-300		Decromet	/
M20-2.5	60-380		Ruspert	/
M22-2.5	70-380			/

**Hexagon Head Bolts, Full Thread**

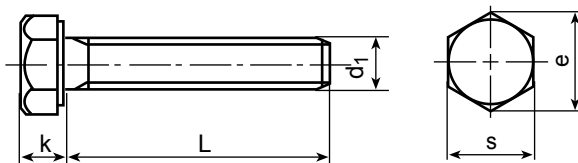

Standard: Din933

Dia.	Length MM	Material /Class	Surface Treatment	Package Pcs/Bundle
M4-0.7	8-40			/
M5-0.8	8-65			/
M6-1.0	10-120	4.8	PLAIN	/
M8-1.25	12-130	8.8	BLACK	/
M10-1.5	16-130	10.9	Z.P.L	/
M12-1.75	45-200	12.9	B.Z.P	/
M14-2.0	50-220		M.Z.P.	/
M16-2.0	60-280	or	H.D.G.	/
M18-2.5	60-300	SSA2/A4	Decromet	/
M20-2.5	60-380	Brass	Ruspert	/
M22-2.5	70-380			/

Fine thread bolt according to Din558 or Din961



Hex Cap Screw (ASTM)

Dia.	Length INCH	Material /Grade	Surface Treatment	Package Pcs/Bundle
1/4"-28	1/4-6			/
5/16"-18	1/2-6		PLAIN	/
3/8"-16	1/2-6		BLACK	/
1/2"-13	3/4-6	2, 5, 8	Z.P.L	/
5/8"-11	3/4-6	or	B.Z.P	/
3/4"-10	3/4-6	SS A2/A4	M.Z.P.	/
7/8"-9	1-1/2-6	Brass	H.D.G.	/
1"-8	1-1/2-6		Decromet	/
1-1/4"-7	1-1/2-6		Ruspert	/
1-1/2"-6	1-1/2-6			/
1-3/4"-5	1-1/2-6			/



# Accessories of Construction

## Bolt

### Carriage Bolt

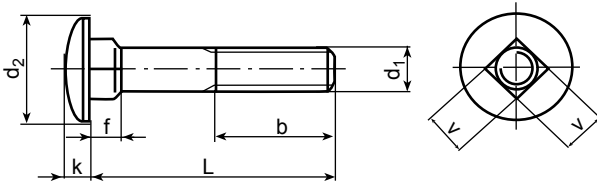

Standard: Din603

Dia.	Length MM	Material /Class	Surface Treatment	Package Pcs/Bundle
M4-0.7	8-40			/
M5-0.8	8-65			/
M6-1.0	10-120			/
M8-1.25	12-130	4.8	PLAIN	/
M10-1.5	16-130	8.8	BLACK	/
M12-1.75	45-200	or	Z.P.L	/
M14-2.0	50-220	SSA2/A4	B.Z.P.	/
M16-2.0	60-280	Brass	M.Z.P.	/
M18-2.5	60-300		H.D.G.	/
M20-2.5	60-380		Decromet	/
M22-2.5	70-380		Ruspert	/

Carriage Bolt (ASTM)

Dia.	Length INCH	Material /Grade	Surface Treatment	Package Pcs/Bundle
1/4"-28	1/4-6			/
5/16"-18	1/2-6			/
3/8"-16	1/2-6		PLAIN	/
1/2"-13	3/4-6		BLACK	/
5/8"-11	3/4-6	2, 5, 8	Z.P.L	/
3/4"-10	3/4-6	or	B.Z.P	/
7/8"-9	1-1/2-6	SS A2/A4	M.Z.P.	/
1"-8	1-1/2-6	Brass	H.D.G.	/
1-1/4"-7	1-1/2-6		Decromet	/
1-1/2"-6	1-1/2-6		Ruspert	/
1-3/4"-5	1-1/2-6			/

### Hexagon Socket Head Cap Screw

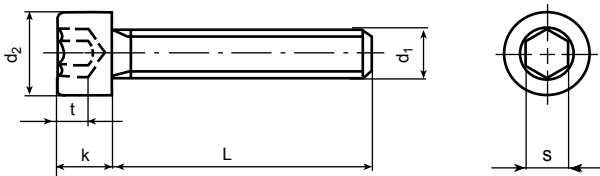

Standard: Din912

Dia.	Length MM	Material /Class	Surface Treatment	Package Pcs/Bundle
M4-0.7	8-40			/
M5-0.8	8-65			/
M6-1.0	10-100	4.8	PLAIN	/
M8-1.25	12-100	8.8	BLACK	/
M10-1.5	16-100	10.9	Z.P.L	/
M12-1.75	45-130	12.9	B.Z.P	/
M14-2.0	50-150	or	M.Z.P.	/
M16-2.0	60-160	SSA2/A4	H.D.G.	/
M18-2.5	60-160	Brass	Decromet	/
M20-2.5	60-180		Ruspert	/
M22-2.5	70-200			/

Socket Head Cap Screw (ASTM)

Dia.	Length INCH	Material /Grade	Surface Treatment	Package Pcs/Bundle
1/4"-28	1/4-6			/
5/16"-18	1/2-6			/
3/8"-16	1/2-6		PLAIN	/
1/2"-13	3/4-6		BLACK	/
5/8"-11	3/4-6	2, 5, 8	Z.P.L	/
3/4"-10	3/4-6	or	B.Z.P	/
7/8"-9	1-1/2-6	SS A2/A4	M.Z.P.	/
1"-8	1-1/2-6	Brass	H.D.G.	/
1-1/4"-7	1-1/2-6		Decromet	/
1-1/2"-6	1-1/2-6		Ruspert	/
1-3/4"-5	1-1/2-6			/

**Hex Flange Screw(ASTM)**

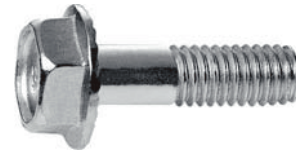
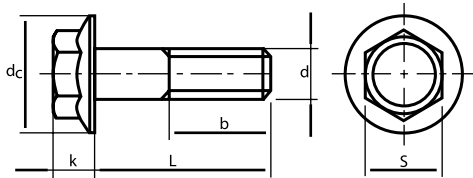

Standard: Din6921

Dia.	Length MM	Material /Class	Surface Treatment	Package Pcs/Bundle
M4-0.7	8-40			/
M5-0.8	8-65			/
M6-1.0	10-100	4.8	PLAIN	/
M8-1.25	12-100	8.8	BLACK	/
M10-1.5	16-100	10.9	Z.P.L	/
M12-1.75	45-130	12.9	B.Z.P	/
M14-2.0	50-150	or	M.Z.P.	/
M16-2.0	60-160	SSA2/A4	H.D.G.	/
M18-2.5	60-160	Brass	Decromet	/
M20-2.5	60-180		Ruspert	/
M22-2.5	70-200			/

Hex Flange Screw

Dia.	Length INCH	Material /Grade	Surface Treatment	Package Pcs/Bundle
1/4"-28	1/4-6			/
5/16"-18	1/2-6		PLAIN	/
3/8"-16	1/2-6		BLACK	/
1/2"-13	3/4-6	2, 5, 8	Z.P.L	/
5/8"-11	3/4-6	or	B.Z.P	/
3/4"-10	3/4-6	SS A2/A4	M.Z.P.	/
7/8"-9	1-1/2-6	Brass	H.D.G.	/
1"-8	1-1/2-6		Decromet	/
1-1/4"-7	1-1/2-6		Ruspert	/
1-1/2"-6	1-1/2-6			/
1-3/4"-5	1-1/2-6			/

**Hexagon Socket Head Cap Screw with Low Head**



Standard: Din7984

Dia.	Length MM	Material /Class	Surface Treatment	Package Pcs/Bundle
M4-0.7	8-40			/
M5-0.8	8-65			/
M6-1.0	10-100	4.8	PLAIN	/
M8-1.25	12-100	8.8	BLACK	/
M10-1.5	16-100	or	Z.P.L	/
M12-1.75	45-130	SSA2/A4	B.Z.P	/
M14-2.0	50-150	Brass	M.Z.P.	/
M16-2.0	60-160		H.D.G.	/
M18-2.5	60-160		Decromet	/
M20-2.5	60-180		Ruspert	/
M22-2.5	70-200			/

**Hexagon Socket Countersuck Head Screw**



Standard: Din7991

Dia.	Length MM	Material /Class	Surface Treatment	Package Pcs/Bundle
M4-0.7	8-40			/
M5-0.8	8-65			/
M6-1.0	10-100	4.8	PLAIN	/
M8-1.25	12-100	8.8	BLACK	/
M10-1.5	16-100	or	Z.P.L	/
M12-1.75	45-130	SSA2/A4	B.Z.P	/
M14-2.0	50-150	Brass	M.Z.P.	/
M16-2.0	60-160		H.D.G.	/
M18-2.5	60-160		Decromet	/
M20-2.5	60-180		Ruspert	/
M22-2.5	70-200			/





**Hexagon Nut**

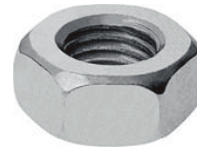
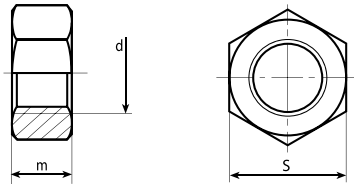

**Standard: Din934 - ISO 4032**

**Finished Hexagon Nut (ASTM)**

Dia.	Length MM	Material /Class	Surface Treatment	Package Pcs/Bundle
M4-0.7	/			/
M5-0.8	/			/
M6-1.0	/	6	PLAIN	/
M8-1.25	/	8	BLACK	/
M10-1.5	/	10	Z.P.L	/
M12-1.75	/	or	B.Z.P	/
M14-2.0	/	SSA2/A4	M.Z.P.	/
M16-2.0	/	Brass	H.D.G.	/
M18-2.5	/		Decromet	/
M20-2.5	/		Ruspert	/
M22-2.5	/			/

Dia.	Length INCH	Material /Grade	Surface Treatment	Package Pcs/Bundle
1/4"-28	/			/
5/16"-18	/			/
3/8"-16	/	2, 5, 8	PLAIN	/
1/2"-13	/	or	BLACK	/
5/8"-11	/	2H	Z.P.L	/
3/4"-10	/	or	B.Z.P	/
7/8"-9	/	SS A2/A4	M.Z.P.	/
1"-8	/	Brass	H.D.G.	/
1-1/4"-7	/		Decromet	/
1-1/2"-6	/		Ruspert	/
1-3/4"-5	/			/

**Hexagon Thin Nut**

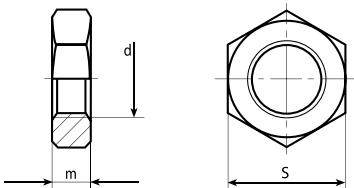

**Standard: Din439**

**Standard: Din936**

Dia.	Length MM	Material /Class	Surface Treatment	Package Pcs/Bundle
M4-0.7	/		PLAIN	/
M5-0.8	/		BLACK	/
M6-1.0	/	6	Z.P.L	/
M8-1.25	/	or	B.Z.P	/
M10-1.5	/	SSA2/A4	M.Z.P.	/
M12-1.75	/	Brass	H.D.G.	/
M14-2.0	/		Decromet	/
M16-2.0	/		Ruspert	/

Dia.	Length MM	Material /Class	Surface Treatment	Package Pcs/Bundle
M4-0.7	/		PLAIN	/
M5-0.8	/		BLACK	/
M6-1.0	/	6	Z.P.L	/
M8-1.25	/	or	B.Z.P	/
M10-1.5	/	SSA2/A4	M.Z.P.	/
M12-1.75	/	Brass	H.D.G.	/
M14-2.0	/		Decromet	/
M16-2.0	/		Ruspert	/

# Accessories of Construction

## Nut

### Hexagon Nylon Insert Lock Nut

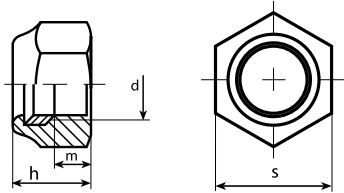

Standard: Din985

Dia.	Length MM	Material /Class	Surface Treatment	Package Pcs/Bundle
M4-0.7	/			/
M5-0.8	/			/
M6-1.0	/	6	PLAIN	/
M8-1.25	/	8	BLACK	/
M10-1.5	/	10	Z.P.L	/
M12-1.75	/	or	B.Z.P	/
M14-2.0	/	SSA2/A4	M.Z.P.	/
M16-2.0	/	Brass	H.D.G.	/
M18-2.5	/		Decromet	/
M20-2.5	/		Ruspert	/
M22-2.5	/			/



Nylon Insert Lock Nut (ASTM)

Dia.	Length INCH	Material /Grade	Surface Treatment	Package Pcs/Bundle
1/4"-28	/			/
5/16"-18	/			/
3/8"-16	/	2, 5, 8	PLAIN	/
1/2"-13	/	or	BLACK	/
5/8"-11	/	2H	Z.P.L	/
3/4"-10	/	or	B.Z.P	/
7/8"-9	/	SS A2/A4	M.Z.P.	/
1"-8	/	Brass	H.D.G.	/
1-1/4"-7	/		Decromet	/
1-1/2"-6	/		Ruspert	/
1-3/4"-5	/			/

### Prevailing Torque Hexagon Nylon Insert Lock Nut

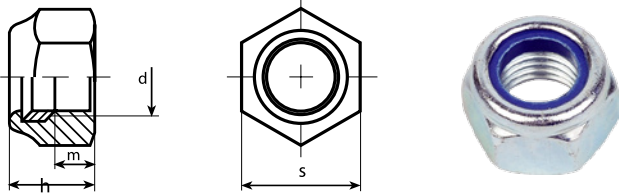

Standard: Din982

Dia.	Length MM	Material /Class	Surface Treatment	Package Pcs/Bundle
M4-0.7	/			/
M5-0.8	/			/
M6-1.0	/	6	PLAIN	/
M8-1.25	/	8	BLACK	/
M10-1.5	/	10	Z.P.L	/
M12-1.75	/	or	B.Z.P	/
M14-2.0	/	SSA2/A4	M.Z.P.	/
M16-2.0	/	Brass	H.D.G.	/
M18-2.5	/		Decromet	/
M20-2.5	/		Ruspert	/
M22-2.5	/			/

### Hexagon Domed Cap Nut

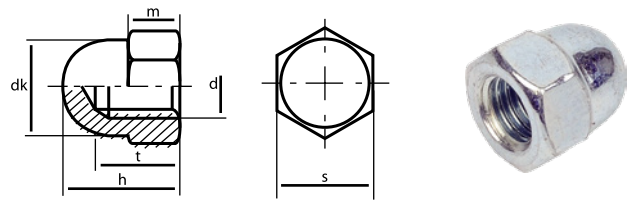

Standard: 1587

Dia.	Length INCH	Material /Grade	Surface Treatment	Package Pcs/Bundle
M4-0.7	/			/
M5-0.8	/			/
M6-1.0	/	6	PLAIN	/
M8-1.25	/	8	BLACK	/
M10-1.5	/	10	Z.P.L	/
M12-1.75	/	or	B.Z.P	/
M14-2.0	/	SSA2/A4	M.Z.P.	/
M16-2.0	/	Brass	H.D.G.	/
M18-2.5	/		Decromet	/
M20-2.5	/		Ruspert	/
M22-2.5	/			/

**Hexagon Flange Nut**

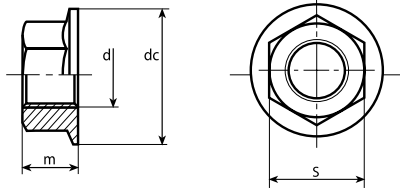

Standard: Din6923

Dia.	Length MM	Material /Class	Surface Treatment	Package Pcs/Carton
M6-1.0	/			/
M8-1.25	/	6	Z.P.L	/
M10-1.5	/	8	B.Z.P	/
M12-1.75	/	10	M.Z.P.	/
M14-2.0	/	or	H.D.G.	/
M16-2.0	/	SS A2/A4	Ruspert	/
M18-2.5	/	Brass		/
M20-2.5	/			/

Hex Flange Nut (ASTM)

Dia.	Length INCH	Material /Grade	Surface Treatment	Package Pcs/Carton
1/4"-28	/			/
5/16"-18	/		PLAIN	/
3/8"-16	/	2, 5, 8	BLACK	/
1/2"-13	/	or	Z.P.L	/
5/8"-11	/	2H	B.Z.P	/
3/4"-10	/	or	M.Z.P.	/
7/8"-9	/	SS A2/A4	H.D.G.	/
1"-8	/	Brass	Decromet	/
1-1/4"-7	/		Ruspert	/
1-1/2"-6	/			/
1-3/4"-5	/			/

**Hexagon Coupling Nut**

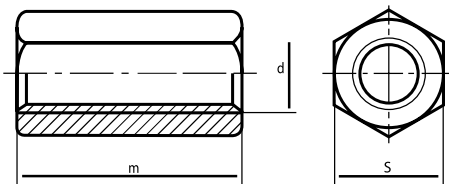

Standard: Din6334

Dia.	Length MM	Material /Class	Surface Treatment	Package Pcs/Carton
M6-1.0	18			/
M8-1.25	24			/
M10-1.5	30	6	Z.P.L	/
M12-1.75	36	or	B.Z.P	/
M14-2.0	42	SS A2/A4	M.Z.P.	/
M16-2.0	48	Brass	H.D.G.	/
M18-2.5	54		Ruspert	/
M20-2.5	60			/
M22-2.5	66			/

Hexagon Coupling Nut (ASTM)

Dia.	Length INCH	Material /Grade	Surface Treatment	Package Pcs/Carton
1/4"-28	1-1/4		PLAIN	/
5/16"-18	1-3/4		BLACK	/
3/8"-16	1-3/4	2, 5, 8	Z.P.L	/
1/2"-13	1-3/4	or	B.Z.P	/
5/8"-11	1-3/4	SS A2/A4	M.Z.P.	/
3/4"-10	2-1/4	Brass	H.D.G.	/
7/8"-9	2-1/4		Decromet	/
1"-8	2-1/4		Ruspert	/



## Accessories of Construction

### Nut

#### Hexagon Weld Nut



Standard: Din929

Dia.	Length MM	Material /Class	Surface Treatment	Package Pcs/Carton
M6-1.0	/	6	PLAIN BLACK Z.P.L	/
M8-1.25	/			/
M10-1.5	/			/
M12-1.75	/			/
M14-2.0	/			/

#### Square Weld Nut



Standard: Din928

Dia.	Length MM	Material /Class	Surface Treatment	Package Pcs/Carton
M6-1.0	/	6	PLAIN BLACK Z.P.L	/
M8-1.25	/			/
M10-1.5	/			/
M12-1.75	/			/
M14-2.0	/			/

#### Wing Nut



Standard: Din315

Dia.	Length MM	Material /Class	Surface Treatment	Package Pcs/Carton
M6-1.0	/	6	PLAIN BLACK Z.P.L	/
M8-1.25	/			/
M10-1.5	/			/
M12-1.75	/			/
M14-2.0	/			/

#### T-Nut



Standard: Din1624

Dia.	Length MM	Material /Class	Surface Treatment	Package Pcs/Carton
M6-1.0	/	6	PLAIN BLACK Z.P.L	/
M8-1.25	/			/
M10-1.5	/			/
M12-1.75	/			/
M14-2.0	/			/



# Accessories of Furniture & House Decoration

Machine/ Wood / Tapping / Drilling Screws - Washer

## Slotted Pan Head Machine Screw

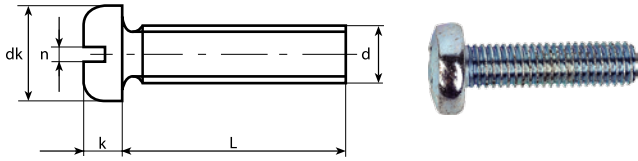

Standard: Din85

Dia.	Length MM	Material /Class	Surface Treatment	Package Pcs/Carton
M3-0.5	8-40	4.8	PLAIN	/
M3.5-0.6	8-65		BLACK	/
M4-0.7	10-120	SS A2/A4	Z.P.L	/
M5-0.8	12-130	Brass	B.Z.P	/
M6-1.0	16-130			/

## Slotted Chesse Head Machine Screw

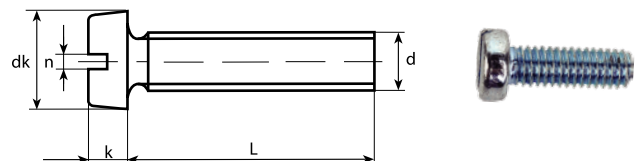

Standard: Din84

Dia.	Length MM	Material /Class	Surface Treatment	Package Pcs/Carton
M3-0.5	8-40	4.8	PLAIN	/
M3.5-0.6	8-65		BLACK	/
M4-0.7	10-120	SS A2/A4	Z.P.L	/
M5-0.8	12-130	Brass	B.Z.P	/
M6-1.0	16-130			/

## Slotted CSK Head M/S

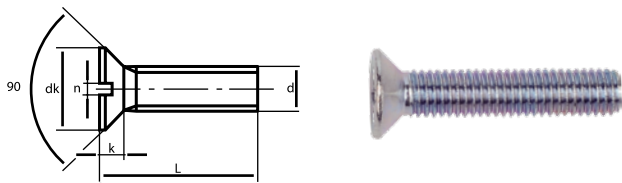

Standard: Din963

Dia.	Length MM	Material /Class	Surface Treatment	Package Pcs/Carton
M3-0.5	8-40	4.8	PLAIN	/
M3.5-0.6	8-65		BLACK	/
M4-0.7	10-120	SSA2/A4	Z.P.L	/
M5-0.8	12-130	Brass"	B.Z.P	/
M6-1.0	16-130			/

## Slotted Raised CSK Head M/S

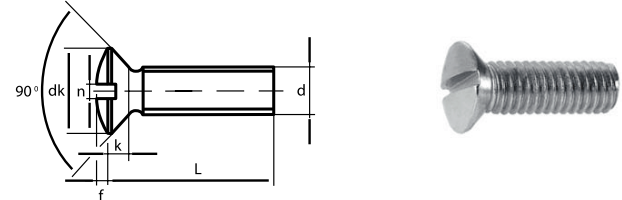

Standard: Din964

Dia.	Length MM	Material /Class	Surface Treatment	Package Pcs/Carton
M3-0.5	8-40	4.8	PLAIN	/
M3.5-0.6	8-65		BLACK	/
M4-0.7	10-120	SSA2/A4	Z.P.L	/
M5-0.8	12-130	Brass	B.Z.P	/
M6-1.0	16-130			/

## Cross Recessed CSK Head Screw

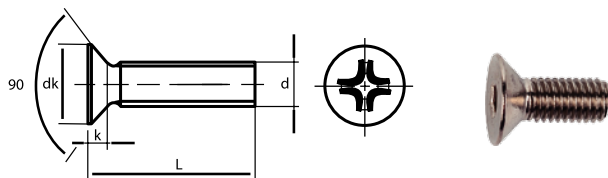

Standard: Din965

Dia.	Length MM	Material /Class	Surface Treatment	Package Pcs/Carton
M3-0.5	8-40	4.8	PLAIN	/
M3.5-0.6	8-65		BLACK	/
M4-0.7	10-120	SSA2/A4	Z.P.L	/
M5-0.8	12-130	Brass	B.Z.P	/
M6-1.0	16-130			/

## Cross Recessed Raised CSK M/S

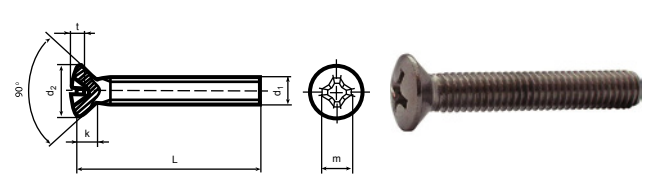

Standard: Din966

Dia.	Length MM	Material /Class	Surface Treatment	Package Pcs/Carton
M3-0.5	8-40	4.8	PLAIN	/
M3.5-0.6	8-65		BLACK	/
M4-0.7	10-120	SSA2/A4	Z.P.L	/
M5-0.8	12-130	Brass	B.Z.P	/
M6-1.0	16-130			/



**Pozi Drive/Phillips Drive DCSK Head Chipboard Screw**

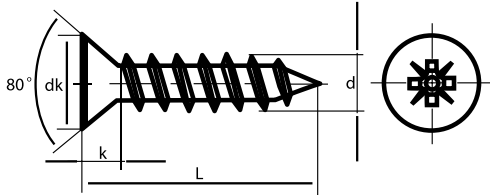

Standard: Din7505-A (Pozi Drive)

Standard: Chipboard Screw (Phillips Drive)

Dia.	Length MM	Material /Class	Surface Treatment	Package Pcs/Carton
M2.5	8-30	C1022 Harden	Z.P.L. B.Z.P. Ni. P.	/
M3.0	10-50			/
M3.5	10-60			/
M4	12-80			/
M4.5	16-80			/
M5	25-120			/
M6	30-200			/

Dia.	Length INCH	Material /Grade	Surface Treatment	Package Pcs/Carton
#6	3/8~2-1/2	C1022 Harden	Z.P.L. B.Z.P. Ni. P.	/
#8	3/8~3-1/2			/
#10	1/2~3			/
#12	1~4-3/4			/
#14	1-1/2~8			/

**Pozi Drive/Phillips Raised Cheese Head Chipboard Screw**

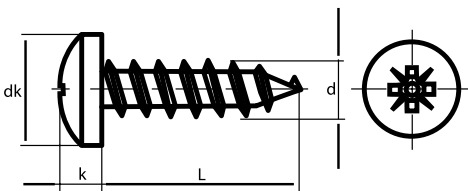

Standard: Din7505-B (Pozi Drive)

Standard: Chipboard Screw (Phillips Drive)

Dia.	Length MM	Material /Class	Surface Treatment	Package Pcs/Carton
M2.5	8-30	C1022 Harden	Z.P.L. B.Z.P. Ni. P.	/
M3.0	10-50			/
M3.5	10-60			/
M4	12-80			/
M4.5	16-80			/
M5	25-120			/
M6	30-200			/

Dia.	Length INCH	Material /Grade	Surface Treatment	Package Pcs/Carton
#6	3/8~2-1/2	C1022 Harden	Z.P.L. B.Z.P. Ni. P.	/
#8	3/8~3-1/2			/
#10	1/2~3			/
#12	1~4-3/4			/
#14	1-1/2~8			/

**Phillips Bugle Head Drywall Screw, Coarse/Fine Thread**



Standard: Drywall Screw

Dia.	Length MM	Material /Grade	Surface Treatment	Package Pcs/Carton
M3.5	10-75	C1022 Harden	B.P. G.P.	/
M3.9	11-75			/
M4.2	10-100			/
M4.8	13-152			/

Dia.	Length INCH	Material /Class	Surface Treatment	Package Pcs/Carton
6#	3/8~2-1/2	C1022 Harden	B.P. G.P.	/
7#	3/8~3-1/2			/
8#	3/8~3-1/2			/
10#	1/2~3			/
12#	1~4-3/4			/
14#	1-1/2~8			/

## Accessories of Furniture & House Decoration

Machine/ Wood / Tapping / Drilling Screw - Washer

### Modify Truss Head Chipboard Screw



Standard: Modify Truss Head CBS, Sharp

Dia.	Length MM	Material /Class	Surface Treatment	Package Pcs/Carton
4.2	10-76	C1022 Harden	Z.P.L. B.Z.P. Ni. P.	/

### Modify Truss Head Self-Drilling Screw



Standard: Modify Truss Head Self-drilling S.

Dia.	Length MM	Material /Class	Surface Treatment	Drill Point #
4.2	10-76	C1022 Harden	Z.P.L. B.Z.P. Ni. P.	3

### Pan Framing Head Dry Wall Screw Sharp Point



Standard: Pan Framing Head DWS

Dia.	Length MM	Material /Class	Surface Treatment	Package Pcs/Carton
4.2	10-76	C1022 Harden	Z.P.L. B.Z.P. Ni. P.	/

### Pan Framing Head Self-Drilling DWS



Standard: Modify Truss Head Self-drilling S.

Dia.	Length MM	Material /Class	Surface Treatment	Drill Point #
4.2	10-76	C1022 Harden	Z.P.L. B.Z.P. Ni. P.	3

### Bugle Head Self-Drilling Dry Wall Screw



Standard: Bugle Head Self-drilling DWS

Dia.	Length MM	Material /Class	Surface Treatment	Drill Point #
M3.5	10-60	C1022 Harden	Z.P.L. B.P. G.P.	2
M4.2	12-80			



Standard: Bugle Head Self-drilling DWS

Dia.	Length INCH	Material /Class	Surface Treatment	Drill Point #
#6-20	1-2	C1022 Harden	Z.P.L. B.P. G.P.	2
#8-20	1-3			

**Hanger Bolt**



Standard: Hanger Bolt

Dia.	Length MM	Material /Class	Surface Treatment	Package Pcs/Carton
M6	60-80	C1022 Harden	Z.P.L.	/
M8	50-220		B.Z.P.	/
M10	50-220		Ni. P.	/
M12	100-220			/

**Torx Flat Head Concrete Screw**



Standard: Concrete Screw (Big / Small Head)

Dia.	Length MM	Material /Class	Surface Treatment	Drill Point #
7.5	42-212	C1022 Harden	Z.P.L. B.Z.P. Ni. P.	/

**Furniture Screw**



Standard: Furniture Screw

Dia.	Length MM	Material /Class	Surface Treatment	Drive Type
5.0	30, 40, 50	C1022	Z.P.L.	Pozi,
6.4	30, 40, 50		B.Z.P.	w/Hole,
7.0	50, 60, 70		Ni. P.	w/Hole

**Euro Screw**



Standard: Euro Screw

Dia.	Length MM	Material /Class	Surface Treatment	Drive Type
6.3	9-20	C1022	Z.P.L. B.Z.P. Ni. P.	Pozi, w/Hole, w/Hole

**Hexagon Head Wood Screw**



Standard: Din571

Dia.	Length MM	Material /Class	Surface Treatment	Package Pcs/Carton
M5	20-80	4.8 or SS A2/A4	PLAIN Z.P.L. Decromet Ruspert"	/
M6	20-150			/
M7	30-160			/
M8	20-200			/
M10	30-300			/
M12	40-300			/
M16	50-300			/



## Accessories of Furniture & House Decoration

Machine/ Wood / Tapping / Drilling Screw - Washer

### Hexagon Washer Head Tapping Screw



Standard: Din6928

Dia.	Length MM	Material /Class	Surface Treatment	Package Pcs/Carton
2.9	8-30	C1022 Harden or SS A2/A4	PLAIN Z.P.L. Ni.P	/
3.5	10-50			/
3.9	10-60			/
4.2	12-80			/
4.8	16-80			/
5.5	25-80			/
6.3	30-100			/

### Slotted Pan Head Self-Tapping Screw



Standard: Din7971

Dia.	Length MM	Material /Class	Surface Treatment	Package Pcs/Carton
2.9	8-30	C1022 Harden or SS A2/A4	PLAIN Z.P.L. Ni.P Decromet Ruspert	/
3.5	10-50			/
3.9	10-60			/
4.2	12-80			/
4.8	16-80			/
5.5	25-80			/
6.3	30-100			/

### Slotted CSK Head Self-Tapping Screw



Standard: Din7972

Dia.	Length MM	Material /Class	Surface Treatment	Package Pcs/Carton
2.9	8-30	C1022 Harden or SS A2/A4	PLAIN Z.P.L. Ni.P Decromet Ruspert	/
3.5	10-50			/
3.9	10-60			/
4.2	12-80			/
4.8	16-80			/
5.5	25-80			/
6.3	30-100			/

### Cross Recessed Pan Head Tapping Screw



Standard: Din7981

Dia.	Length MM	Material /Class	Surface Treatment	Package Pcs/Carton
2.9	8-30	C1022 Harden or SS A2/A4	PLAIN Z.P.L. Ni.P Decromet Ruspert	/
3.5	10-50			/
3.9	10-60			/
4.2	12-80			/
4.8	16-80			/
5.5	25-80			/
6.3	30-100			/

### Cross recessed CSK Self-Tapping Screw



Standard: Din7982

Dia.	Length MM	Material /Class	Surface Treatment	Package Pcs/Carton
2.9	8-30	C1022 Harden or SS A2/A4	PLAIN Z.P.L. Ni.P Decromet Ruspert	/
3.5	10-50			/
3.9	10-60			/
4.2	12-80			/
4.8	16-80			/
5.5	25-80			/
6.3	30-100			/

### Cross Recessed Raised CSK T/S



Standard: Din7983

Dia.	Length MM	Material /Class	Surface Treatment	Package Pcs/Carton
2.9	8-30	C1022 Harden or SS A2/A4	PLAIN Z.P.L. Ni.P Decromet Ruspert	/
3.5	10-50			/
3.9	10-60			/
4.2	12-80			/
4.8	16-80			/
5.5	25-80			/
6.3	30-100			/

**Cross Recessed CSK Head Self-Drilling Screw with Tapping thread**

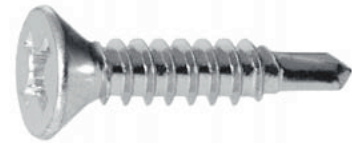
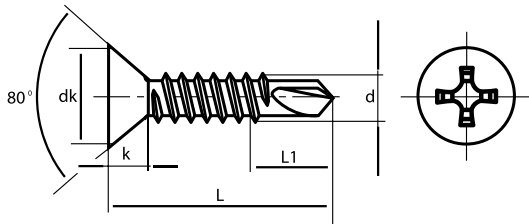

Standard: Din7504-P

Dia.	Length MM	Material /Class	Surface Treatment	Drilling Point #
3.5	9.5-19	C1022	Z.P.L.	2
3.9	9.5-25	Harden	M.Z.P.L.	2
4.2	32-50	or	Decromat	2
4.8	13-50	SS A2/A4	Ruspert	3

Standard: CSK Head Self-Drilling Screw

Dia.	Length INCH	Material /Class	Surface Treatment	Package Pcs/Carton
#6	3/8~3/4	C1022	Z.P.L.	2
#7	3/8~1	Harden	M.Z.P.L.	2
#8	1-1/4~2	or	Decromat	2
#9	1/2~2	SS A2/A4	Ruspert	3

**Hexagon Head Self-Drilling Screw with Tapping thread**

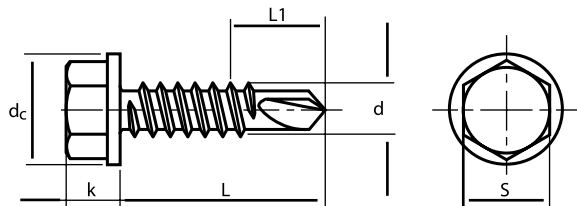

Standard: Din7504-K

Dia.	Length MM	Material /Class	Surface Treatment	Drilling Point #
3.5	9.5-19	C1022	Z.P.L.	2
3.9	9.5-25	Harden	M.Z.P.L.	2
4.2	32-50	or	Decromat	2
4.8	13-50	SS A2/A4	Ruspert	3

Standard: Hex Head Self-Drilling Screw

Dia.	Length INCH	Material /Class	Surface Treatment	Package Pcs/Carton
#6	3/8~3/4	C1022	Z.P.L.	2
#7	3/8~1	Harden	M.Z.P.L.	2
#8	1-1/4~2	or	Decromat	2
#9	1/2~2	SS A2/A4	Ruspert	3

**Cross Recessed Pan Head Self-Drilling Screw with Tapping thread**

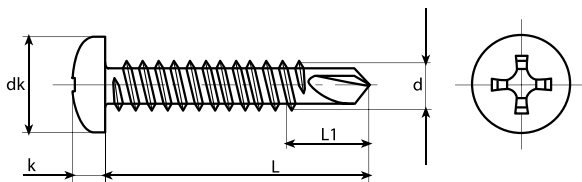

Standard: Din7504-N

Dia.	Length MM	Material /Class	Surface Treatment	Drilling Point #
3.5	9.5-19	C1022	Z.P.L.	2
3.9	9.5-25	Harden	M.Z.P.L.	2
4.2	32-50	or	Decromat	2
4.8	13-50	SS A2/A4	Ruspert	3

Standard: Pan Head Self-Drilling Screw

Dia.	Length INCH	Material /Class	Surface Treatment	Package Pcs/Carton
#6	3/8~3/4	C1022	Z.P.L.	2
#7	3/8~1	Harden	M.Z.P.L.	2
#8	1-1/4~2	or	Decromat	2
#9	1/2~2	SS A2/A4	Ruspert	3

# Accessories of Furniture & House Decoration

## Machine/ Wood / Tapping / Drilling Screw - Washer

### Hexagon Head Self-Drilling Screw with EPDM Washer

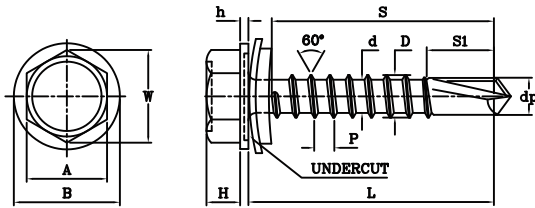

Dia.	Length MM	Material /Class	Surface Treatment	Drilling Point #
3.5	13-25	C1022	Z.P.L.	2
4.2	13-75	Harden	M.Z.P.L.	2
4.8	13-100	or	Decromat	3
5.5	19-125	SS A2/A4	Ruspert	3
6.3	19-250			3

Dia.	Length INCH	Material /Class	Surface Treatment	Drilling Point #
#6	1/2-1	C1022	Z.P.L.	2
#8	1/2~3	Harden	M.Z.P.L.	2
#10	1/2~4	or	Decromat	3
#12	3/4~5	SS A2/A4	Ruspert	3
#14	3/4~10			3

### Painted Hexagon Head Self-Drilling Screw with EPDM Washer

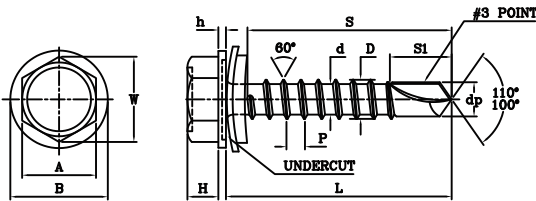

Dia.	Length MM	Material /Class	Surface Treatment	Drilling Point #
4.8	19-70	C1022 Harden or	Z.P.L. M.Z.P.L. Decromat	1
5.5	25-75	SS A2/A4	Ruspert	1

Dia.	Length MM	Material /Class	Surface Treatment	Drilling Point #
#10	3/4~2-3/4	C1022 Harden or	Z.P.L. M.Z.P.L. Decromat	1
#12	1~3	SS A2/A4	Ruspert	1

Painting color can be fully according to customers' requirements, which with Ral or Pantone Color Standards.

### Hex Flange Head Self-Drilling Screw, with EPDM washer



Dia.	Length MM	Material /Class	Surface Treatment	Drilling Point #
#10	25-68	C1022	Z.P.L. M.Z.P.L.	3
#12	25-100	Harden	Decromat Ruspert	4

**Flat Washer**

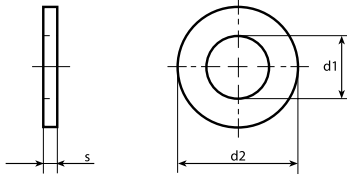

Standard: Din125A-Din126-Din9021-Din440R

SAE-USS-FENDER WASHER-F436 (ASTM)

Dia.	Length MM	Material /Class	Surface Treatment	Package Pcs/Carton
M4	/			/
M5	/			/
M6	/			/
M8	/	Low Carbon	PLAIN	/
M10	/	Steel	BLACK	/
M12	/	or	Z.P.L	/
M14	/	SSA2/A4	B.Z.P	/
M16	/	Brass	M.Z.P.	/
M18	/		H.D.G.	/
M20	/		Decromat	/
M22	/		Ruspert	/

Dia.	Length INCH	Material /Grade	Surface Treatment	Package Pcs/Carton
1/4"	/			/
5/16"	/			/
3/8"	/	Low Carbon	PLAIN	/
1/2"	/	Steel	BLACK	/
5/8"	/	or	Z.P.L	/
3/4"	/	SSA2/A4	B.Z.P	/
7/8"	/	Brass	M.Z.P.	/
1"	/	or	H.D.G.	/
1-1/4"	/	Hardened	Decromat	/
1-1/2"	/	for F436	Ruspert	/
1-3/4"	/			/

**Spring Washer**

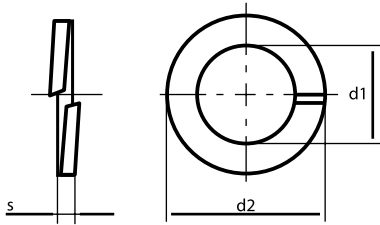

Standard: Din127B-Din7980

Split Lock Washer

Dia.	Length MM	Material /Class	Surface Treatment	Package Pcs/Carton
M4	/			/
M5	/			/
M6	/			/
M8	/	Low Carbon	PLAIN	/
M10	/	Steel	BLACK	/
M12	/	or	Z.P.L	/
M14	/	SSA2/A4	B.Z.P	/
M16	/	Brass	M.Z.P.	/
M18	/		H.D.G.	/
M20	/		Decromat	/
M22	/		Ruspert	/

Dia.	Length INCH	Material /Grade	Surface Treatment	Package Pcs/Carton
1/4"	/			/
5/16"	/			/
3/8"	/	Low Carbon	PLAIN	/
1/2"	/	Steel	BLACK	/
5/8"	/	or	Z.P.L	/
3/4"	/	SSA2/A4	B.Z.P	/
7/8"	/	Brass	M.Z.P.	/
1"	/		H.D.G.	/
1-1/4"	/		Decromat	/
1-1/2"	/		Ruspert	/
1-3/4"	/			/



## Other Accessories

Rivet Nut - Pin - Rivet - Anchor

### Rivet Nut



Flat Head Round Plain Body

Thread	Grip Range	Hole Size	Surface Treatment	Package Pcs/Carton
M3-0.5	0.5-1.5	5.0		/
M4-0.7	1.0-3.5	6.0	Z.P.L	/
M5-0.8	2.5-5.0	7.0	B.Z.P	/
M6-1.0	3.0-5.5	9.0	Ni.P	/
M8-1.25	3.5-6.0	11.0	Decromet	/
M10-1.5	2.5-4.0	13.0	Ruspert	/
M12-1.75	4.0-6.5	15.0-16.0		/
M16-2.0	3.0-9.0	21.0		/



Flat Head Round Knurled Body

Thread	Grip Range	Hole Size	Surface Treatment	Package Pcs/Carton
M3-0.5	0.5-1.5	5.0		/
M4-0.7	1.0-3.5	6.0	Z.P.L	/
M5-0.8	2.5-5.0	7.0	B.Z.P	/
M6-1.0	3.0-5.5	9.0	Ni.P	/
M8-1.25	3.5-6.0	11.0	Decromet	/
M10-1.5	2.5-4.0	13.0	Ruspert	/
M12-1.75	4.0-6.5	15.0-16.0		/
M16-2.0	3.0-9.0	21.0		/



Flat Head Full Hex Body

Thread	Grip Range	Hole Size	Surface Treatment	Package Pcs/Carton
M4-0.7	1.0-3.5	6.0		/
M5-0.8	2.5-5.0	7.0	Z.P.L	/
M6-1.0	3.0-5.5	9.0	B.Z.P	/
M8-1.25	3.5-6.0	11.0	Ni.P	/
M10-1.5	2.5-4.0	13.0	Decromet	/
M12-1.75	4.0-6.5	15.0-16.0	Ruspert	/
M16-2.0	3.0-9.0	21.0		/



Flat Head Semi-Hex Body

Thread	Grip Range	Hole Size	Surface Treatment	Package Pcs/Carton
M4-0.7	1.0-3.5	6.0		/
M5-0.8	2.5-5.0	7.0	Z.P.L	/
M6-1.0	3.0-5.5	9.0	B.Z.P	/
M8-1.25	3.5-6.0	11.0	Ni.P	/
M10-1.5	2.5-4.0	13.0	Decromet	/
M12-1.75	4.0-6.5	15.0-16.0	Ruspert	/
M16-2.0	3.0-9.0	21.0		/



Countersunk Head Knurled Body

Thread	Grip Range	Hole Size	Surface Treatment	Package Pcs/Carton
M4-0.7	1.0-3.5	6.0	Z.P.L	/
M5-0.8	2.5-5.0	7.0	B.Z.P	/
M6-1.0	3.0-5.5	9.0	Ni.P	/
M8-1.25	3.5-6.0	11.0	Decromet	/
M10-1.5	2.5-4.0	13.0	Ruspert	/
M12-1.75	4.0-6.5	15.0-16.0		/

**Rivet Nuts**



**Reduced Head Knurled Body**

Thread	Grip Range	Hole Size	Surface Treatment	Package Pcs/Carton
M3-0.5	0.5-1.5	5.0	Z.P.L B.Z.P Ni.P	/
M4-0.7	1.0-3.5	6.0		/
M5-0.8	2.5-5.0	7.0		/
M6-1.0	3.0-5.5	9.0	Decromet Ruspert	/
M8-1.25	3.5-6.0	11.0		/
M10-1.5	2.5-4.0	13.0		/
M12-1.75	4.0-6.5	15.0-16.0		/
M16-2.0	3.0-9.0	21.0		/



**Reduced Head Knurled Body Imperial Hole**

Thread	Grip Range	Hole Size	Surface Treatment	Package Pcs/Carton
M3-0.5	0.5-1.5	4.8	Z.P.L	/
M4-0.7	1.0-3.5	6.4	B.Z.P	/
M5-0.8	2.5-5.0	7.2	Ni.P	/
M6-1.0	3.0-5.5	9.6	Decromet Ruspert	/
M8-1.25	3.5-6.0	10.6		/
M10-1.5	2.5-4.0	12.8		/



**Reduced Hex Head Full-Hex Body**

Thread	Grip Range	Hole Size	Surface Treatment	Package Pcs/Carton
M4-0.7	1.0-3.5	6.0	Z.P.L B.Z.P Ni.P	/
M5-0.8	2.5-5.0	7.0		/
M6-1.0	3.0-5.5	9.0		/
M8-1.25	3.5-6.0	11.0	Decromet Ruspert	/
M10-1.5	2.5-4.0	13.0		/
M12-1.75	4.0-6.5	15.0-16.0		/



**RHH Inner-Hex Body Imperial Hole**

Thread	Grip Range	Hole Size	Surface Treatment	Package Pcs/Carton
M4-0.7	1.0-3.5	6.4	Z.P.L	/
M5-0.8	2.5-5.0	7.2	B.Z.P	/
M6-1.0	3.0-5.5	9.6	Ni.P	/
M8-1.25	3.5-6.0	10.6	Decromet Ruspert	/



**Flat Head Round Body Close End Rivet Nut**

Thread	Grip Range	Hole Size	Surface Treatment	Package Pcs/Carton
M4-0.7	1.0-3.5	6.4	Z.P.L	/
M5-0.8	2.5-5.0	7.2	B.Z.P	/
M6-1.0	3.0-5.5	9.6	Ni.P	/
M8-1.25	3.5-6.0	10.6	Decromet Ruspert	/

## Other Accessories

Rivet Nut - Pin - Rivet - Anchor

### Wedge Anchors

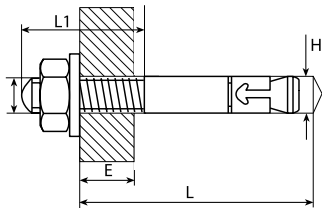

Standard: Wedge Anchor

Dia.	Length MM	Material /Class	Surface Treatment	Hole Size
M6-1.0	40-140	4.8 or SS A2/A4	PLAIN	6mm
M8-1.25	50-220		Z.P.L	8mm
M10-1.5	55-360		M.Z.P.	10mm
M12-1.75	65-360		H.D.G.	12mm
M16-2.0	80-350		Decromet	16mm
M20-2.5	100-400		Ruspert	20mm
M24	180-360			24mm

Standard: Wedge Anchor

Dia.	Length INCH	Material /Class	Surface Treatment	Hole Size
1/4"	1-3/4~3-3/4	4.8 or SS A2/A4	PLAIN	1/4"
3/8"	2-1/4~5		Z.P.L	3/8"
1/2"	2-3/4~5-1/2		M.Z.P.	1/2"
5/8"	3-1/2~10		H.D.G.	5/8"
3/4"	4-1/4~12		Decromet	3/4"
7/8"	6~10		Ruspert	7/8"
1"	6~12			1"

### Drop-in-anchor



Standard: Drop in Anchor

Dia.	Length MM	Material /Class	Surface Treatment	Hole Size
M6	*8*25	4.8 or SS A2/A4	PLAIN	6mm
M8	*10*30		Z.P.L	8mm
M10	*12*40		M.Z.P.	10mm
M12	*16*50		H.D.G.	12mm
M16	*18*55		Decromet	16mm
M20	*20*60		Ruspert	20mm
M24	*24*80			24mm

### Metal Frame Anchor



Standard: Metal Frame Anchor

Dia.	Length INCH	Material /Class	Surface Treatment	Hole Size
M6	*8*25	4.8 or SS A2/A4	PLAIN	6mm
M8	*10*30		Z.P.L	8mm
M10	*12*40		M.Z.P.	10mm
M12	*16*50		H.D.G.	12mm
M16	*18*55		Decromet	16mm
M20	*20*60		Ruspert	20mm
M24	*24*80			24mm

### Sleeve Anchor Bolt / Nut Type



Standard: Sleeve Anchor Bolt / Nut Type

Dia.	Length INCH	Material /Class	Surface Treatment	Hole Size
M8	40-80	4.8 or SS A2/A4	PLAIN	8mm
M10	50-140		Z.P.L	10mm
M12	65-150		M.Z.P.	12mm
M16	80-200		H.D.G.	16mm
M20	100-250		Decromet	20mm

**Blind Rivet**



Standard: Din7337B, Blind Rivet

Dia.	Length MM	Material /Class	Surface Treatment	Package Q-ty
3.2mm	6-25	Metal & Aluminum	Z.P.L	/
4.0mm	6-25		Ni.P	/
4.8mm	6.4-35		Decromet	/
6.4mm	10-30			/

**Split Pin**



Standard: Din94, Split Pin

Dia.	Length MM	Material /Class	Surface Treatment	Package Q-ty
1.0mm	6-18	A3	Z.P.L B.L.K.	/
1.6mm	8-28			/
2.0mm	10-40			/
2.5mm	12-50			/
3.2mm	18-80			/

**Spring Pin**



Standard: Din1481, Spring Pin

Dia.	Length MM	Material /Class	Surface Treatment	Package Q-ty
1.0mm	1.2	Carbon Steel Mn65	B.L.K. Z.P.L	/
1.5mm	1.7			/
2mm	2.3			/
2.5mm	2.8			/
3.0mm	3.3			/
4.0mm	4.4			/
5.0mm	5.4			/
6.0mm	6.4			/
8.0mm	8.5			/
10.0mm	10.5			/

**Retaining Ring**



Standard: Din471, Circlip for Shafts

Dia.	Retaining Size	Material /Grade	Surface Treatment	Package Q-ty
3.0mm	2.55-2.74	Carbon Steel	B.L.K. Z.P.L	/
4.0mm	3.55-3.74			/
5.0mm	4.55-4.74			/
...	...			/
280mm	263-265.81			/
290mm	273-275.81			/
300mm	283-285.81			/

Standard: Din472, Circlip for Bores

Dia.	Retaining Size	Material /Grade	Surface Treatment	Package Q-ty
8.0mm	806-9.06	Carbon Steel	B.L.K. Z.P.L	/
9.0mm	9.7-10.16			/
...	...			/
290mm	304.99-3.7			/
300mm	314.99-3.17			/



## Other Accessories

Steel Link Chain, Wire Rope & Ringing

### Steel Link Chain



Standard: Din763, Din766, Steel Link Chain

Dia.	Working Load	Testing Load (N)	Breaking Load(N)	Surface Treatment
2mm	25	800	1,250	PLAIN Z.P.L. M.Z.P.
3mm	55	1,050	3,200	
4mm	100	2,500	6,500	
5mm	160	4,000	10,000	
6mm	200	5,000	12,000	
8mm	400	10,000	25,000	
10mm	630	16,000	40,000	

### Steel Link Chain



Standard: Din5685A/C, Steel Link Chain

Dia.	Working Load	Testing Load (N)	Breaking Load(N)	Surface Treatment
2mm	7	500	1,025	PLAIN Z.P.L. M.Z.P.
3mm	15	1,120	2,800	
4mm	30	2,000	5,000	
5mm	50	3,150	7,750	
6mm	73	4,500	11,500	
8mm	130	8,000	20,000	
10mm	205	12,500	31,000	

### Steel Wire Rope



Size Available	Core	Surface	Packing
6*13	FI or FC	PLAIN Z.P.L. M.Z.P.	/
6*19			
6*24			
6*37			
8*19			
8*24			
8*37			

### Ringing



Din741



Din5299C



Snap Hook



Quick Link



Din580



Din582



Din1480



Dee Shakle





**GUF**  
AUFASTER  
HARDWARE

**Haining Aufaster Trading Co.,Ltd**

ADD: Room 1102-1104 Grand Luck Mansion,  
No.499 Nongfeng Road, Haining,  
Zhejiang, China

TEL: +86-573-87002390, 87002391

FAX: +86-573-87002392

Email: vincent@aufaster.com

info@aufaster.com

Http://www.aufaster.com